

The JA-159J Wireless doorbell button

The JA-159J is a component of the JABLOTRON 100 system. Button activation can be used for such functions as a wireless doorbell button, to trigger a panic alarm or to operate various electrical appliances. The button is powered by two batteries, communicates via JABLOTRON wireless protocol and takes up one position in the system. The detector should be installed by a trained technician with a valid certificate issued by an authorized distributor.

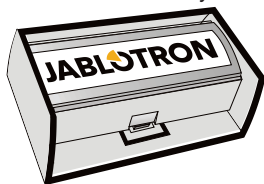

Installation

Always install the button with a protective roof which also serves as the doorbell button's base. The design of the protective roof design allows installation of multiple doorbell buttons on top of each other. Never place a doorbell button on or near metal objects because they may negatively affect communication range. The JA-11xR radio module must be installed in the control panel in order for the bell button to function.

1. Install the doorbell roof onto the selected place using two screws which are included in the packaging. It is necessary to use countersunk screws; tighten them properly so the button can be inserted and secured in the doorbell roof properly (mind the imperfections of the surface).
2. Remove the doorbell button cover by pushing it upwards gently with a flat screwdriver.
3. Insert a label (size 18x65 mm), which can be printed using a Brother PT-xxx series printer and the F-Link software, into the label cover. Reassemble the button and the label cover. The printing procedure is identical to printing keypad labels for JA-192E keypad segments.
4. Attach the button to the top part of the roof as indicated by arrow number 1 on figure 2a and then secure it by sliding it downwards into the grooves, which is indicated by arrow number 2. If the button is going to be removed from the base, it is necessary to release it by pushing the screwdriver onto the tab (figure 2c).
5. Follow the instructions in the control panel installation manual. Basic procedure:
 - a. Open the **F-Link** software, select the required position in the **Devices** window and launch enrollment mode by clicking on the Enroll button.
 - b. Hold down the bell button for at least 6 seconds to send an enrollment signal to the control panel.
6. Configure the doorbell button following the Setting *properties* section.

Note:

- The button can be enrolled to the system by entering its production code on the rear of the device in the F-Link software. All digits of the production code are required (1400-00-0000-0001).
- If you want to remove the detector from the control panel, erase it from its position.

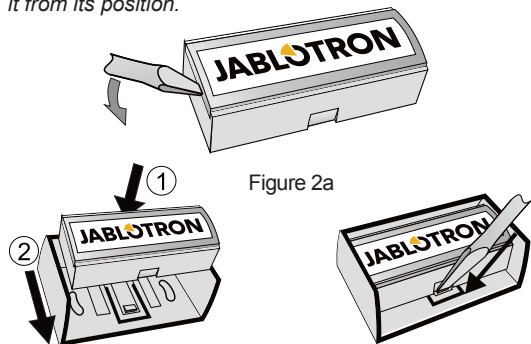

Figure 2b

Figure 2c

Using the doorbell functionality

The first condition to use the door button is that at least one of the indoor sirens be enrolled in the system in order to use the doorbell function.

The second condition is that a PG output must be assigned to the activation of the doorbell button, which is done on the doorbell button's position in the F-Link software.

Open the "Signalling PG" tab in the internal settings of an indoor siren and select a sound or a melody which will be played in reaction to the activation of the PG output. It is possible for the doorbell button to have no reaction, meaning the reaction is set to None.

Operation with a multipurpose relay (MPR)

The remote control can also be enrolled to a multipurpose relay of the AC-16x series in order to control a relay according to the chosen mode. One doorbell may even be enrolled to multiple MPRs using different functions. If the doorbell button is enrolled to the control panel and also to an MPR within its RF range, activation of the doorbell button will trigger reactions in both devices. To enroll a keyfob to an MPR, follow the installation manual of the MPR.

Note:

- The doorbell button is capable of sending pulses repeatedly in 1s intervals when the button is pressed continuously. This is suitable when using with a device where it is necessary to use different time periods of output activation.

Setting the properties

Perform settings using the **F-Link** software – **Devices** tab. Click on the JA-159's **Internal settings** button to display a window where you can set the following parameters:

Taking over a user's access privileges: The transmitter can use the access privileges and Time limited access (if enabled) of a selected user to control sections assigned to this user. Factory default settings: disabled.

Taking over a user's identity: The selected user will be visible as the source in the event log. Factory default settings: disabled.

Battery replacement

The control panel automatically reports a low battery status. It is not necessary to switch it to Service mode because the doorbell button does not have a tamper contact. The button can be disassembled after removing the label cover and a screw underneath it following figure 2a. Wait for 10 seconds at least or press the button repeatedly in order to deplete the remaining charge before inserting new batteries. We recommend using batteries supplied by a distributor or other quality batteries. **Always replace both batteries.**

Do not throw the used batteries into the garbage, but dispose of them according to local regulations.

Label printing

It is possible to utilize the same printers and principles which are used to print JABLOTRON 100 segment keypad labels. The only difference is using a wider 18 mm tape PT-TAPE18-BW. In order to print a label, use the "Print labels" button in the doorbell's internal settings in F-Link.

Technical specifications

Power supply	2x lithium battery type CR 2032 (3.0 V / 0.2 Ah) (Power supply type C, according to EN 50131-6)
Typical battery lifetime:	approx. 5 years (3 activations per day, outdoor)
Communication band	868.1 MHz, JABLOTRON protocol
Communication range	approx. 300 m (open area)
Environment according to EN 50131-1	Class III outdoor-sheltered
IP rating	IP65
Operational temperature range	-25 to +60 °C
Relative air humidity	25 to 75%
Dimensions, weight	70 x 30 x 20 mm, 37 g
Dimensions, weight (including the roof cover)	77 x 47 x 28 mm, 60 g
Operational conditions	ERC REC 70-03
Also complies with	ETSI EN 300220, EN 55032:2015, EN 50130-4+A1:2014, EN 62368-1, EN 50581:2012



JABLOTRON ALARMS a.s. hereby declares that the JA-159J is in a compliance with the relevant European Union harmonisation legislation: Directives No: 2014/53/EU, 2014/35/EU, 2014/30/EU, 2011/65/EU. The original of the conformity assessment can be found at www.jablotron.com - Downloads Section.

Note: Although this product does not contain any harmful materials we suggest you return the product to the dealer or directly to the producer after use.