



YLI ELECTRONIC

# Access Control Keypad with Waterproof



## INTRODUCTION

YK-768 Series is a standalone for two doors, support card, pin, card+pin access way. It is with 2 relays to control 2 doors and supports up to 2000 users in total, each user can possess one card and one pin. It can directly drive lock, alarm, ring bell and also can connect with exit button and door contact.

There are 7 working mode with this device.

1.Wieland Reader, 2.Standalone for single door, 3.standalone for two doors, 4.with external reader for two doors 5.two units interlocked for two doors, 6.Anti-passback for single door, 7.Anti-passback for two door.

Besides, it also supports 1 master code,2 manager card, 2 Anti-duress card users and 2 Anti-duress PIN users, providing users with easy operations and safety reliability.

## FEATURES

- 1.Pure Zinc alloy case; waterproof conform to IP 68
- 2.Built-in 125KHz OR 13.56MHz card reader; Built-in 125KHz and 13.56MHz card reader.
- 3.Perfect digital backbit key, the back light can be set to normal ON, normal OFF or human approach ON.
- 4.With anti-tamper alarm, door contact alarm, anti-duress alarm function
- 5.Add and delete card user quickly with manager cards
- 6.Can register and delete user via keypad
- 7.Master can open the door when entering the setting status
- 8.Mufti working modes: reader, one door, two door, interlock, anti-passback and so on, suitable for many occasions

## SPECIFICATION

- Dimension: L145xW58xD24(mm)(A)  
L120xW80xD22(mm)(B)
- Input Voltage: AC/DC 12V
- Idle Current: <25mA
- Lock output load: <1A
- Alarm output load: <1A
- Ring bell load: <1A
- Card reading distance: 40mm Max
- Card Frequency: 125KHz for EM and HID  
13.56MHz for Mi fare
- Card transmission format 26-37 bit Wieland
- Keypad transmission format:4bit,8bit and Virtual  
card number
- Operating Temperature:-45°C ~55°C
- Operating Humidity:0%~95%
- Weight: 0.5kg

## INSTALLATION

- Remove the back cover from the keypad using the supplied special screw driver
- Drill 2 holes on the wall for the Self tapping screws and 1 hole for the cable
- Put the supplied rubber bungs to into the two holes
- Fix the back cover firmly on the wall with 2 Self tapping screws
- Thread the cable through the cable hole

Attach the keypad to the back cover.

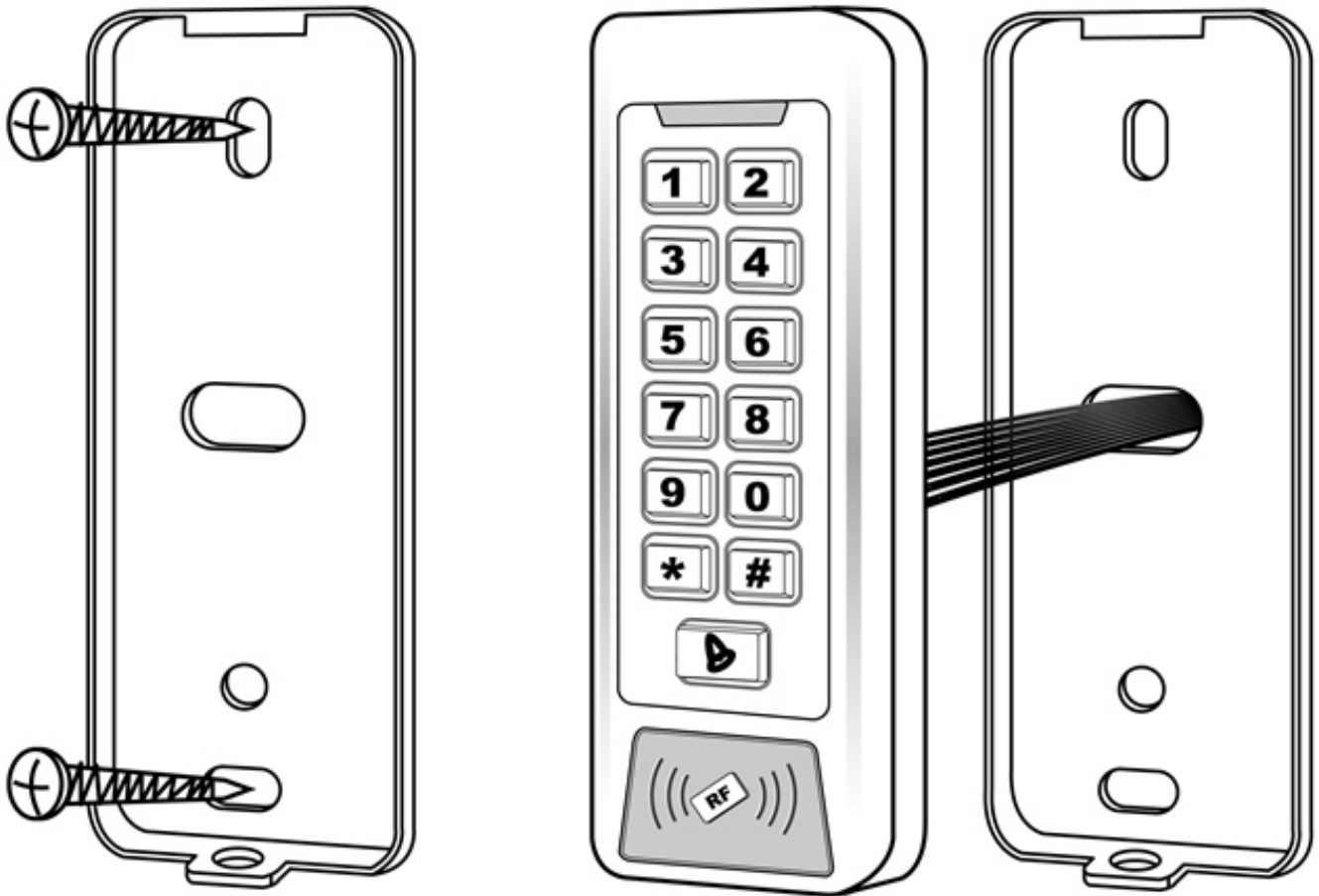

## WIRING

## SOUND AND LIGHT INDICATION

ZONE1				ZONE2		
NO.	Marks	Color	Description	Marks	Color	Description
1	BELL_A	Pink	Doorbell button	D0	Green	Wiegand output D0
2	BELL_B	Pink	Doorbell button	D1	White	Wiegand output D1
3	ALARM+	Red	Alarm anode	AC1	Red	AC1 (+12V)
4	AC2	Black	AC input	GND	Black	GND
5	OPEN2	Yellow	Exit button	OPEN1(BZ)	Yellow	Exit button(for green LED)
6	D_IN2	Brown	Door contact	D_IN1(LED)	Brown	Door contact(for buzzer)
7	ALARM2-	Gray	Alarm 2	ALARM1-	Gray	Alarm 1
8	NO2	Blue	Relay 2 NO end	NO1	Blue	Relay 1 NO end
9	COM2	Purple	Relay2Com	COM1	Purple	Relay1 Com
10	NC2	Orange	Relay2 NC end	NC1	Orange	Relay1 NC end

Operation	LED Color	Buzzer
Standby	Red flash	
Press key		Di
Read card	Green	Di-
Door 1 Open	Green	Di-
Door 2 Open	Green Flash	Di-
Operation Successful	Green	Di-
Operation Failed		DiDiDi
PIN Inputting	Red	
Card&PIN Reading	Red	
Multi Card Reading	Red	
Under Menu	Red	
Under Setting	Orange	
Manager Card Enter	Orange	DiDi
Manager Card Exit	Red flash	Di-
Alarm	Red quick flash	Alarm

# QUICK PROGRAMMING GUIDE

## 1 Administrator Setting

Stand by	Master Code	Menu	Setting	Remarks	Functions
Red Flash	Red	Red	Orange		
★	Master code #	00	New master code# Repeat new master code #(Note:Code length:6-8 digits)	Factory default: 999999	Change the master code
		01	Read Manager Add Card	Default:Zone 1	Set Manager Add Card
		02	Read Manager Delete Card		Set Manager Delete Card
		03	Read Anti-duress card (Zone 1)		Set Zone1 Anti-duress card
		04	Read Anti-duress card (Zone 2)		Set Zone2 Anti-duress Card
		05	Anti-duress PIN# (Zone 1)		Set Zone1 Anti-duress PIN
		06	Anti-duress PIN# (Zone 2)		Set Zone2 Anti-duress PIN
		07	0000#		Delete All Users
		51			Master open Lock 1
		52			Master open Lock 2

## 2 User setting for Zone 1

Stand by	Master Code	Menu	Setting	Remarks	Functions
Red Flash	Red	Red	Orange		
★	Master code #	11	Read card	Users can be added continuously without exiting programming mode	To add card users
			User ID number# read card		
			Card number#		
			ID number#card number#		
			User ID number#PIN#		
		12	Read card	Users can be deleted continuously without exiting programming mode	To delete users
			User ID number#		
			Card number#		
		13	0#	Default 2	Entry by Card
			1#		Entry by card+PIN
			2#		Entry by either Card or PIN
		14	0-99#	Default 5	Set door relay time
		15	0#	Default 0	Relay Setting-Pulse mode
			1#		Relay Setting-Toggle mode
16	1-10#	Default 1	To set open door by multi cards		
17	User ID number#,card number #,card quantity#		To add a series cards users		

## User setting for Zone 2

Stand by	Master Code	Menu	Setting	Remarks	Functions
Red Flash	Red	Red	Orange		
★	Master code #	21	Read card	Users can be added continuously without exiting programming mode	To add card users
			User ID number# read card		
			Card number#		
			ID number#card number#		
			User ID number#PIN#		
		22	Read card	Users can be deleted continuously without exiting programming mode	To delete users
			User ID number#		
			Card number#		
		23	0#	Default 2	Entry by Card
			1#		Entry by card+PIN
			2#		Entry by either Card or PIN
		24	0-99#	Default 5	Set door relay time
		25	0#	Default 0	Relay Setting-Pulse mode
			1#		Relay Setting-Toggle mode
26	1-10#	Default 1	To set open door by mufti cards		
27	User ID number#,card number #,card quantity#		To add a series cards users		

## 3 System Setting

Stand by	Master Code	Menu	Setting	Remarks	Functions
Red Flash	Red	Red	Orange		
★	Master code #	30	0-15#	Default 0	To set facility code
		31	0#	When device reset to factory default ,the setting is still valid	Wiegand reader
			1#		Standalone for single door(Factory default setting)
			2#		Standalone for two doors
			3#		With external reader for two doors
			4#		Two units interlocked for two doors
			5#		Anti-passback for single door
			6#		Anti-passback for two door
		32	26-37#	Default 26	To set Wieland format
		33	0-2#	When device reset to factory default ,the setting is still valid	To set keypad transmission format
		34	1-3#	Default 1	To set alarm time

		35	0#	Default 0	Safe mode 0
			1#		Safe mode 1
			2#		Safe mode 2

#### 4 User optional setting

Stand by	Master Code	Menu	Setting	Remarks	Functions
Red Flash	Red	Red	Orange		
*	Master code #	41	0#		Buzzer will be in silence except enter the programming mode
		42	1#	Default 1	Buzzer will sound when press the key
			0#		Disable keypad backlight
			1#		Enable keypad backlight
			2#	Default 2	Automatic mode, Normally it is off (sleeping mode) but wake up with human approach
		43	0#		LED Light Disable when stand-by status
	1#	Default 1	LED flash when stand-by status		

#### Instruction:

- 1.Master code must be 6-8 digits, Anti-duress PIN must be 8 digits, user PIN is 4-6 digits, The 1<sup>st</sup> digit of user PIN and Anti-duress PIN in Zone1 must be 1; The 1<sup>st</sup> digit of user PIN and Anti-duress PIN in Zone 2 must be 2.
- 2.The user ID number is any number among 1-2000,Invalid 0 can be omitted; card number must be 8 or 10 digits, if the card number is less than 8 or 10 digits, input 0 before the card number.
- 3.Door open time is 0-99 second,0=50mS
- 4.When register one card user into the device, the device will automatically generate a PIN 1234 , this PIN cant open the door .
- 5.When an invalid master pin is pressed the device will go back to the standby status after 5 seconds, when a valid PIN is entered it will go back to standby status after 30 seconds.
- 6.in operating the keypad, pressing # means to confirm the input digits ,In operation of a cycle adding or deleting cards, pressing # means to end the cycle operation and back the up operation; pressing \* means to exit the operation.
7. When add a series cards, this unit will make the ID number and card number initial value; after adding one user, then it will increase the ID number and card number automatically ,Until the specified number of card is added. the card number must be consecutive card quantity is between 1-2000.
8. Working mode and keypad transmission format have been set before shipping, customer can change according to requirement, but when device reset to factory default, the setting is still valid.
- 9.when users of Zone 1 is registered successfully, LED will turn green; when users of Zone 2 is registered successfully, LED will be green flash.

## ADMINISTRATOR SETTING

Administrator setting on keypad

Press \* Master code # factory default:999999,

### 8.1 Change the master code

Press 00 new code # repeat new master code#

Note: Master Code length:6~8 digits

### 8.2 Set Manager card

Set manager add card

Press 0 1 read manager add card

Set manager delete card